

**Appendix 2 – Environment Agency Flood Warnings and Emergency Response**

**Overview**

Warnings cover 109 properties at risk of flooding from Ditton Brook at Ditton and 278 properties at risk of flooding from Ditton Brook at Halebank. This covers less than 1% of the properties in the Halton Borough Council area. The EA has flood defences in place along a section of Ditton Brook bounding Ditton and Halebank. There is potential for more FWAs on Bowers Brook and Keckwick Brook.

**Flood Warning Areas**

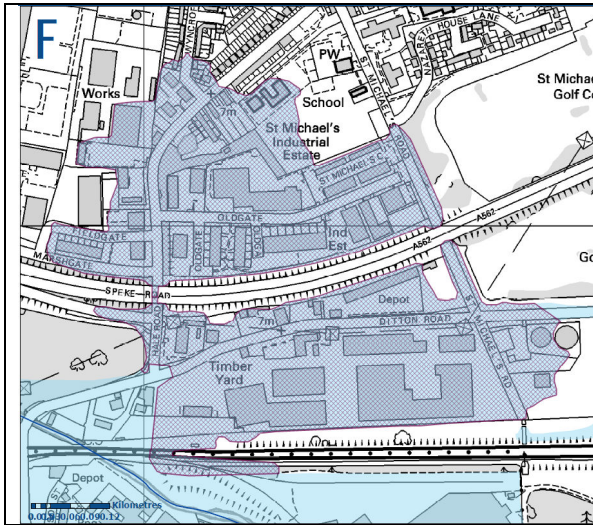

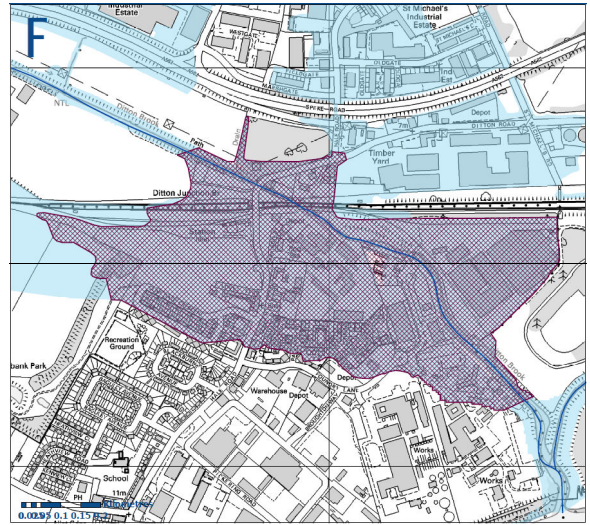

Area	Ditton Brook at Ditton: Hale Road, Oldgate, St Michaels Close Ditton Road Fieldgate Marshgate, Widnes
Properties Affected	109
Status	In Force



Area	Ditton Brook at Halebank Hale Road, Harrison Street, Lovel Terrace and Claggate Crescent Burmash Lane Palmarsh Road Wellingford Avenue Norris Grove Beynard Drive, Widnes
Properties Affected	278
Status	In Force

**EA Flood Alert and Warnings**

	Online flood risk forecast	 FLOOD ALERT	 FLOOD WARNING	 SEVERE FLOOD WARNING	Warning no longer in force
What it means	<b>Be aware. Keep an eye on the weather situation</b>	Flooding is possible. Be prepared	Flooding is expected. Immediate action required	Severe flooding. Danger to life	No further flooding is currently expected in your area
When it is used	Forecasts of flooding on our website are updated at least once a day	Two hours to two days in advance of flooding	Half an hour to one day in advance of flooding	When flooding poses a significant threat to life	When river or sea conditions begin to return to normal
What to do	Check weather conditions. Check for updated flood forecasts on our websites	Be pared to act on your flood plan. Prepare a flood kit of essential items. Monitor local water levels and the flood forecast on our website	Move family, pets and valuables to a safe place. Turn off gas, electricity and water supplies if safe to do so. Put flood protection equipment in place	Stay in safe place with a means of escape. Be ready should you need to evacuate from your home. Co-operate with the emergency services. Call 999 if you are in immediate danger	Be careful. Floodwater may still be around for several days. If you've been flooded, ring your insurance company as soon as possible

When they are issued		
Before	During	After
SFWs should only be issued from a forecast when there won't be time to wait until flooding has begun	Most SFWs should be issued after flooding has already begun	In exceptional circumstances, as flood waters recede, secondary effects such as damaged infrastructure, may justify issuing a SFW

**F.2 Figure 2 Flooding Criteria**

Criteria 1 - Risk to Life	Criteria 2: widespread flooding
<ul style="list-style-type: none"> <li>• Significant risk to life caused by:</li> <li>• deep and fast flowing water (e.g. caused by significant overtopping of defences or sudden onset flooding from dam/defence failure);</li> <li>• rapid onset of flooding;</li> <li>• presence of debris in the water that could cause death or injury;</li> <li>• potential/observed collapse of buildings/structures;</li> <li>• the vulnerability of the population or their surroundings (e.g. deep/fast flowing water through a caravan park).</li> </ul>	<ul style="list-style-type: none"> <li>• Significant disruption to communities:</li> <li>• likely to affect whole community;</li> <li>• community isolated by floodwaters with no obvious means of escape;</li> <li>• critical resources/infrastructure for communities disabled (e.g. no access to food, water, electricity);</li> <li>• emergency services and authorities unable to cope with large volumes of evacuees and rest centres at full capacity;</li> <li>• mutual aid/military support necessary or called upon.</li> </ul>

## **Halton Borough Council Sandbag Policy**

Halton Borough Council Highways Department will be responsible for maintaining adequate stocks for flood defence at agreed levels, and will monitor the adequacy and levels of stock as required by flood incidents.

Resources for Deployment:

The Highways Term Maintenance Contractor will deploy flood defence equipment/stocks under instruction from designated Council officers/staff.

Sandbags:

Highways hold stocks of sandbags for immediate deployment at the following locations;

- Picow Farm Road Depot, Runcorn – in one of two containers within a part of the Bridges store.
- Lower House Lane, Widnes – within the grit storage compound there is a steel container filled with sandbags.

Highways sandbag stocks will be maintained at the agreed level of 1,500 and will be split between Runcorn and Widnes.

Previous policy regarding sandbag provision was to the effect that up to ten sandbags would be provided free of charge to Halton residents or businesses, on a request from them during a Flood Alert. It is proposed to continue with this historical policy. Once sandbags were deployed to premises, the property owners would be responsible for their removal. HBC would not return used sandbags to store (due to potential contamination concerns), or dispose of them unless there was a specific valid request e.g. disability of homeowner.

Floodgates:

A stock of "Floodgates" is held by Highways and at present they are located at Picow Farm Road depot. Highways staff will instruct residents how to fix the Floodgates when residents request them. Equipment remains the property of HBC and will be on loan to residents requesting them. Residents will be asked to keep the Floodgates in a safe and proper location to maintain their condition, and to sign for receipt of them.

Before Floodgates are issued to properties at risk, Highways staff are to visit the premises to ascertain the suitability of the premises for Floodgate protection. (Some properties are not suitable for Floodgate protection without modification.)

**Principal Contact Numbers**

Emergency Authorities	Address	Web Address
Cheshire Police	Oakmere Road, Winsford Tel: 01244 350 000	<a href="http://www.cheshire.police.uk">www.cheshire.police.uk</a>
Cheshire Fire and Rescue Service	Headquarters, Winsford Tel: 01606 868700	<a href="http://www.cheshirefire.gov.uk">www.cheshirefire.gov.uk</a>
Cheshire and Merseyside Ambulance Service	Elm House, Belmont Grove, Anfield, Liverpool, Tel: 0151 260 5220	<a href="http://www.nwas.nhs.uk">www.nwas.nhs.uk</a>
Scottish Power Manweb	Tel: 0845 272 2424	<a href="http://www.scottishpower.com">http://www.scottishpower.com</a>
Transco	Tel: 0800 111 999	<a href="http://www.nationalgrid.com/uk">http://www.nationalgrid.com/uk</a>
United Utilities	Leaks: 0800 330033, Water Supply: 0845 746 2200	<a href="http://www.unitedutilities.com">http://www.unitedutilities.com</a>
Environment Agency	Emergencies (24-hour) Tel: 0800 807 060	<a href="http://www.environment-agency.gov.uk">http://www.environment-agency.gov.uk</a>
Flood line	(24-hour) Tel: 0845 988 1188	<a href="http://www.environment-agency.gov.uk">http://www.environment-agency.gov.uk</a>